

Control cabinet keys

For control panels (electrical panels), electrical cabinets, gas and water taps, and for air-conditioning and ventilation system installations, taps for valves, sanitary ware, window fixtures, etc.



Type with synthetic resin body with fibreglass reinforcing and swivel, die cast zinc sockets

With magnetic retention sockets for coupling 1/4" inserts



Pen style with pocket clip

Support with 2 swivel sockets with the following sockets:

2 \bigcirc x 5, 6-8 mm - 1 \triangle x 9 mm - 1 \bigcirc x 3-5 mm

Supplied with 2 double bits \ominus 7,0x1,2 mm and \oplus PH 2 and \oplus T20 - \oplus T25, and additional coupling for 1/4" bits

Overall length 145 mm

Code M 7108 9000	M 7108/9	Each €	1
------------------	----------	--------	---

Version with contactless voltage tester up to 600 V (50-60 Hz) and optical indicator (green LED) for magnetic fields

Support with 2 swivel sockets with the following sockets:

2 \bigcirc x 6 and 8 mm - 1 \triangle x 9 mm - 1 \bigcirc x 3-5 mm

With ON-OFF switch and pocket clip

Supplied with double bit \ominus 7,0x1,2 mm and \oplus PH 2

Powered by 2 batteries (LR44)

Automatic switch-off after about 2 minutes inactivity

Overall length 155 mm

Code M 7108 9900	M 7108/99	Each €	1
------------------	-----------	--------	---

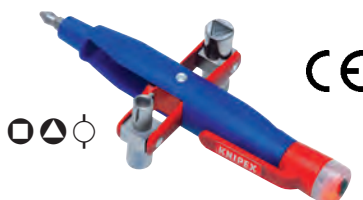
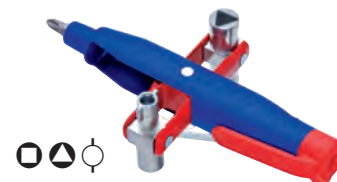

With voltage tester and magnetic fields indicator



Contactless voltage detector → H 9 pag. 702

Hexagonal nut drivers

With **chrome-molybdenum-vanadium steel blade**, completely insulation coated, joined to the hand grip

»felo - Series 400 *ergonic*

Two-component handle with highly flexible synthetic resin cells and soft elastomer that covers it completely, scratch and acid resistant, as well as being pleasant to the touch

With crosswise hole

Fitted with magnetic retention socket to hold screws and make it possible to reach nuts in difficult to reach places, and a spring to make the nut go back onto threaded tie bars

Opening \bigcirc	mm	5,5	6	7	8	10	13
Code	M 7106	0055	0006	0007	0008	0010	0013
M 7106/0	Each €						
Overall length	mm	205	205	205	210	225	230

12 pcs.

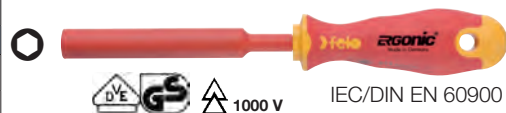
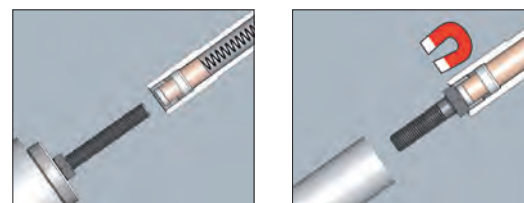

Two-component, ergonomic handle with crosswise hole

Opening \bigcirc	mm	4	5	5,5	6	7	8
Code	M 7106	1004	1005	1055	1006	1007	1008
M 7106/1	Each €						
Overall length	mm	230	230	232	232	237	237

Opening \bigcirc	mm	9	10	11	12	13
Code	M 7106	1009	1010	1011	1012	1013
M 7106/1	Each €					
Overall length	mm	237	237	237	237	237

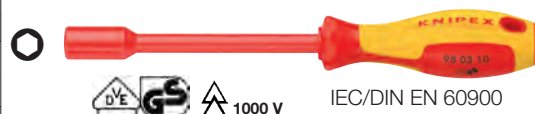

»felo Bit holder handle

With \bigcirc 1/4" drive - Magnetic hold

Chrome-molybdenum-vanadium steel blade, completely insulation coated, joined to the hand grip

Two-component, ergonomic handle with a crosswise hole

Overall length 200 mm

Code M 7107 1000	M 7107/1	Each €	6
------------------	----------	--------	---

Set with inserts with drive \bigcirc 1/4" C 6,3 in nickel-molybdenum-vanadium steel

With 12 tools:

1 hand grip M 7107/1 Overall length 200 mm

4 inserts for slotted screws \ominus - 3,0 - 4,0 - 5,5 - 7,0 mm

3 inserts for "PHILLIPS" screws \oplus - Tip DIN 0 - 1 - 2

2 inserts for "POZIDRIV" screws \oplus - Tip 1 - 2

2 inserts for "TORX" screws \oplus size T15 - T20

Code M 7107 1200	M 7107/12	Each €	6
------------------	-----------	--------	---

\bigcirc 1/4"

frico®

