

BESSEY Toggle clamps

Type with parallel automatic adjustment

Allows for an automatic adaptation to tightening height while maintaining a constant tightening torque

No manual modification to the pressure screw adjustment is required
With adjustment screw located below the articulation lever, to always adapt the tightening force (up to 2500 N) to the specific requirements
With rubber bolt tip
Galvanised finish

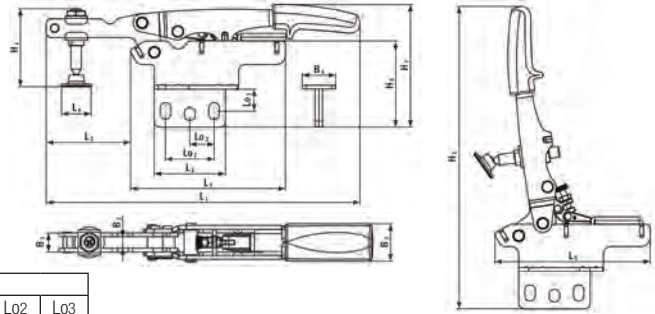
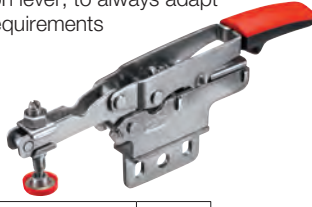

Horizontal version, vertical base
Tightening height adjustable from 0 to 35 mm

Opening mm	Code G 3746	G 3746/8 Each €	Max. force N	Automatic reg. mm	Weight g
35	8000		1100	20	210

6 pieces

Code G 3746	Dimensions mm															
	L1	L2	L4	L5	L6	H1	H2	H4	H5	B1	B2	B3	B4	L01	L02	L03
8000	167	45	16	83	38	65	162	42	45	10	6	20	18	10-13	26	13

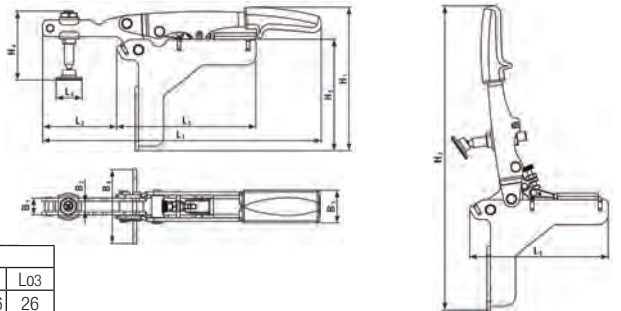

Horizontal version, elbow base
Tightening height adjustable from 0 to 35 mm

Opening mm	Code G 3746	G 3746/9 Each €	Max. force N	Automatic reg. mm	Weight g
35	9000		1100	20	230

6 pieces

Code G 3746	Dimensions mm															
	L1	L2	L4	L5	L6	H1	H2	H4	H5	B1	B2	B3	B4	L01	L02	L03
9000	167	45	16	83	38	85	181	42	66	10	6	20	45	10-30	20-26	26

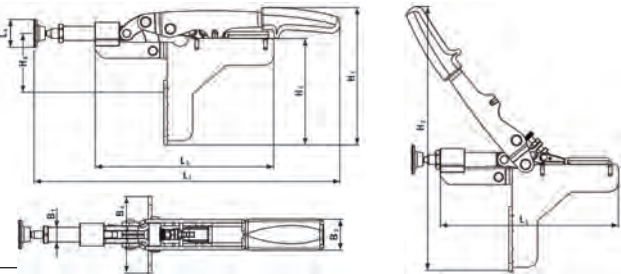

Version with push rod, elbow base
Tightening height adjustable from 0 to 1100 mm

Opening mm	Code G 3746	G 3746/11 Each €	Max. force N	Automatic reg. mm	Weight g
25	1100		1100	8	230

6 pieces

Code G 3746	Dimensions mm											
	L1	L4	L5	H1	H2	H5	B1	B3	B4	L01	L02	L03
1100	181	16	105	81	149	63	34,8	20	45	20,5	20-26	26

G 5

ABC TOOLS Pneumatic fastening device

Fastening action takes place by means of a double-effect cylinder powered at 6.5 Atm

Any lack of pressure does not cause damage because the device is blocked
Base in galvanised sheet steel

Tempered and galvanised pressure screw, with rubber tip

Stainless steel rivets

Weight 0,9 kg

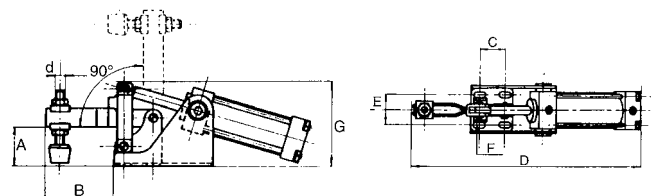

Code G 3747 0000	G 3747	Each €	1
------------------	--------	--------	---

Force N	A mm	B mm	C mm	D mm	E mm	F mm	G mm	d mm
2000	36	64	22	240	32	7 x 9	78	8

